

DantechS

KTL-D-15001



With the KTL-D 15001 model, it is aimed to deliver products in a sustainable manner to retail sales points after production with packaging. Unlike parcel packaging, PE packaging provides more efficient, economical and high quality packaging option. The 2nd packaging machine KTL-D 15001 model is designed with servo-controlled and direct feeding for the packaging of exible products such as diapers, ladies' pads, patient diapers, roll napkins in order to reduce the packaging costs due to parcels.

Servo-controlled intelligent feeding system and the products coming from the 1st packaging outlet are packed with Pe packaging material. The DS 15001, which is managed over Scada with the Sysmac Control system, provides a sustainability advantage at the end of the diaper, sanitary pad and patient diaper production lines with its compact structure.

The patented product also has a design that provides the advantage of packaging with the advanced technology Back Bonding method.



DantechS

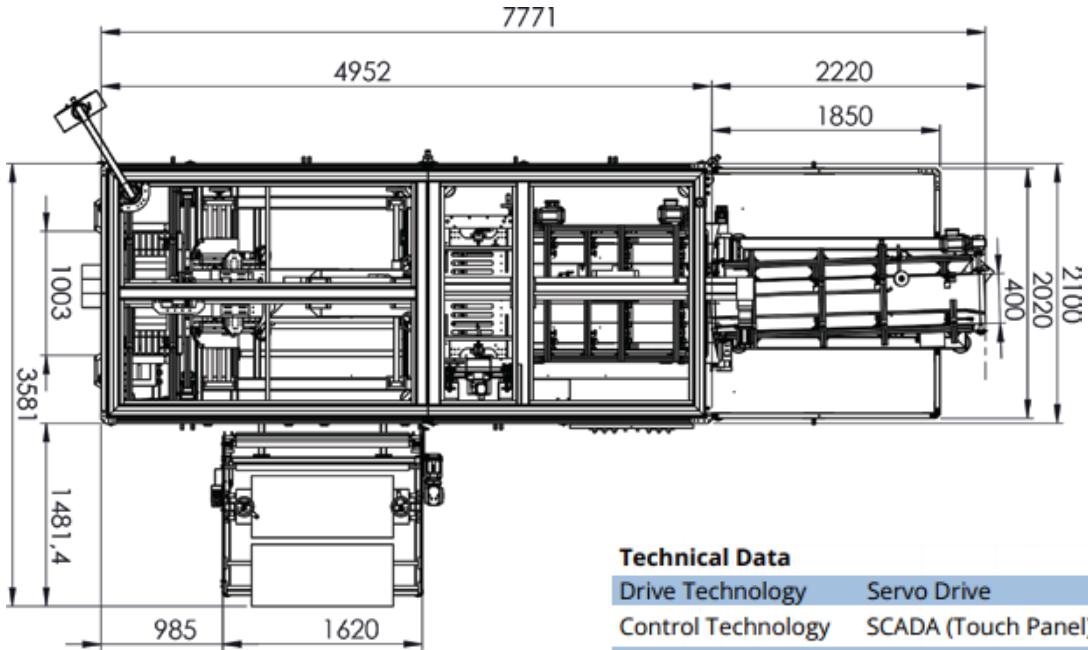

Technical Data

Drive Technology	Servo Drive
Control Technology	SCADA (Touch Panel)
Machine Dimension	7.800 x 3.600 x 2.300 mm
Feed Rate	60 Packs / Minute
Packing Speed	8 Bundles / Minute
Machine Power	11 Kw
Thermal Power	4 Kw
Packaging Material	Pe Foil 0.03 - 0.06 mm

Finished Product Dimensions

Length	150 mm - 700 mm
Width	300 mm - 700 mm
Height	110 mm - 370 mm



DantechS

KTL-Y-16001



ADVANTAGES

- The advantage of packaging different sizes of products in flexible sizes,
- The advantage of packaging in variable sizes with a uniform packaging material,
- Material cost advantage with PE bagging, alternative to the parcel
- High level of space savings in packaging material stock,
- The advantage of PE material, which becomes independent in type turns,
- Sustainability in production,
- Volume advantage in product logistics shipment,
- Standardization advantage in production,
- Personnel (Labor) savings,



DantechS

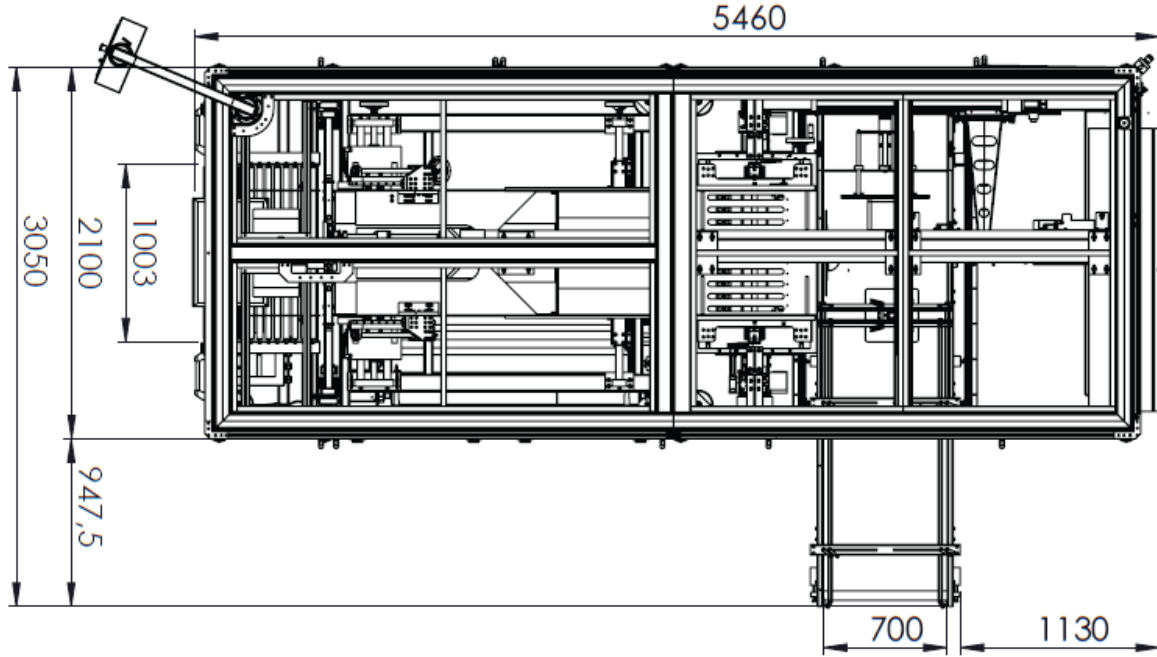

Technical Data

Drive Technology	Servo Drive
Control Technology	SCADA (Touch Panel)
Machine Dimension	5.500 x 2.450 x 2.150 mm
Feed Rate	120 Packs / Minute
Packing Speed	12 Bundles / Minute
Machine Power	15 Kw
Thermal Power	4 Kw

Finished Product Dimensions

Length	150 mm - 700 mm
Width	300 mm - 700 mm
Height	110 mm - 370 mm

Packaging Material Pe Foil 0.03 - 0.06 mm

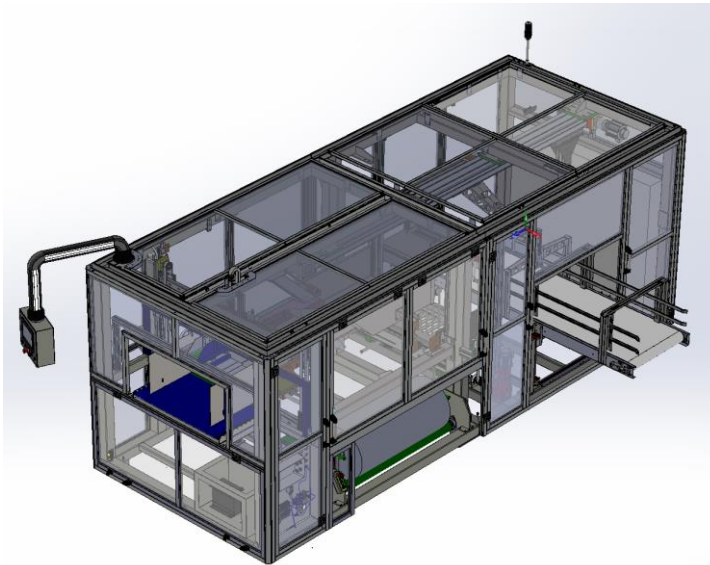

DantechS

Traffic Controlled Transfer Lines



We support your technologies in your factories with our products and solutions that provide speed and efficiency.

- Straight Lines
- 90' - 60' - 45' turns
- Multibelt (Merge) units

Technical Data

Driver	Servo / AC
Control	PLC / Manual
Line Width	100 mm - 2.000 mm
Line Length	Optional
Transfer Speed	3- 50 m/min

Continous Transfer Elevator

Technical Data

Drive Technology	AC Motor
Control Technology	PLC Control
Product Width	150 mm -650 mm
Product Length	200 mm - 700 mm
Transfer Height	15,000 mm (Max)
Feeding Speed	12 Pieces / Minute (Max)



In vertical product transport, with DantechS continuous elevators, we carry your pallets, parcels, boxes, and packed products with two options without stopping. Our elevators that carry metal and rubber chains are produced in modular structure.

The product tilting unit is the parcel etc. on the line. It is designed with the aim of somersaulting the products depending on the operational requirements. The unit, which works with PLC control, is produced in accordance with CE norms on the basis of occupational safety and efficiency. Both units are capable of being integrated into the lines in line with the requirements in your facilities.



Product Tilting Unit

Technical Data

Drive Technology	AC Motor
Control Technology	PLC Control
Product Width	150 mm - 600 mm
Product Length	200 mm - 700 mm
Feeding Speed	10 Pieces / Minute (Max)

DantechS

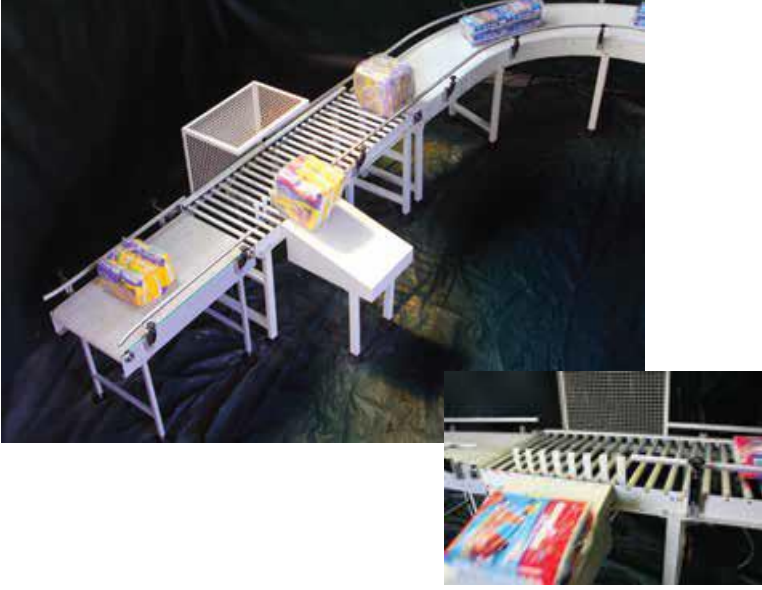

Product Rejecting Unit

Technical Data

Drive Technology	AC Motor
Control Technology	PLC Control
Product Width	150 mm - 500 mm
Product Length	200 mm - 650 mm
Product Height	500 mm (Max)
Feeding Speed	24 Pieces / Minute (Max)

In the hygiene product production lines, it is very important to separate the defective products and packages after the 1st packaging and 2nd packaging machines. This reject process is done with the reject systems designed by DantechS, with sensors or cameras.

In systems with sensors, products are controlled with linear geometry. In systems with cameras, the image is taken and control is made with the software, and the rejected products are thrown out of the line at the smart reject station.

Palletizing Line Conveyors

Pallet conveyors are used for automatic robot palletizing, shipment of palletized products to storage and loading areas.

Pallet conveyors are designed as roller, chain, pop-up, cross and elevator pallet conveyors according to their application areas. We produce light type pallet conveyors for loads between 100-650 kg and heavy type pallet conveyors for loads between 650-1,500 kg for your facilities.

Intelligent pallet conveyors produced with PLC and Scada control also serve in factories and logistics warehouse automations.

DantechS manufactures pallet conveyors in modular standard structures that can be quickly and easily integrated into stretching, strapping, pallet feeding and control systems.

